

# Guide to Using Internet Ports in the Biomedical Library

## Access for UCLA Users

The UCLA Louise M. Darling Biomedical Library has Internet ports in various areas of the library for the use of current UCLA faculty, staff, and students. These ports provide *current UCLA faculty, staff, and students* with Internet access while using a personal laptop. Printing from a laptop is not available in the Library, but users can e-mail or store files on their laptop. **Note:** Wireless connection to the campus network is available throughout the library.

A current UCLA Bruin OnLine (BOL) account is necessary to use the ports. If you have questions about your account, contact the BOL Help Desk at 310/267-4357. If you need to create a free, Bruin OnLine account, go to <<http://www.bol.ucla.edu/services/accounts>> and click .

## Ports

### Locations and Availability

Ports are available on stack levels 4 through 8 and 10 through 11, the Third Floor Graduate Reading Room, and the Journal Reading Room. Electrical outlets are available near some of the ports. See the map on the reverse side of this handout for port locations.

### What Do I Need?

You will need the following items to make a successful connection via the ports:

- ✓ A current Bruin Online account
- ✓ A personal laptop (PC with Win 95/98/ME/NT/2000/XP or Mac with OS 8 and above)
- ✓ A working Ethernet network card or integrated Ethernet
- ✓ A working Ethernet network cable
- ✓ Laptop TCP/IP networking protocol configured for DHCP (i.e., not a static IP)
- ✓ A browser that is Java-capable and set with Java on (Internet Explorer 5.x or above and Netscape 4.7x or above are recommended)

Please note: If the plug on your cable is smaller than the port, you are trying to plug in your modem instead of an Ethernet network card. Consult your laptop vendor to get a purchase recommendation for an appropriate Ethernet network card. Your vendor should also provide help to you with the DHCP configuration on your laptop and new Ethernet card.

## How to Connect Your Laptop

While your laptop is still off, plug in your power and Ethernet cables. Turn on your laptop and let it boot up completely. Make sure the laptop is not booting up from a "suspend" state.

Open your web browser. The first screen that opens will be an "Authentication" page. Enter your BOL username and password in the indicated fields and click the "OK" button. When a second window pops up with the message, "Authentication Successful," just click on the "DONE" button to close it.

For security reasons, there is a 10-minute time-out on the ports. After 10 minutes of inactivity, if you click on a new hyperlink or type a new URL, you will again see the Authentication screen. Re-establish the connection by entering your BOL information

It is the responsibility of the laptop owner to work with their vendor to resolve the complex compatibility issues that arise between different mixes of laptop hardware, software, network cards, operating systems, and other components.

# LOUISE M. DARLING BIOMEDICAL LIBRARY LAPTOP PORT MAP

## FLOOR 1, CURRENT JOURNALS READING ROOM

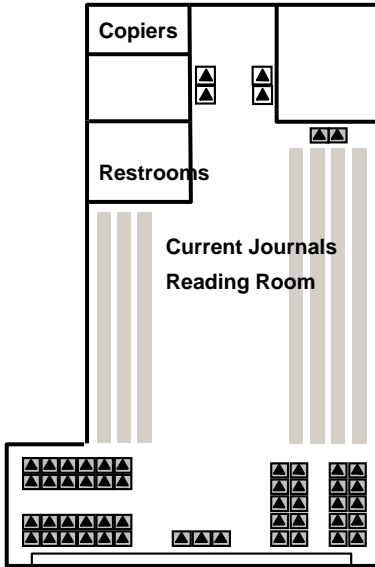

### LEGEND

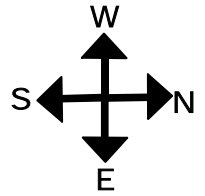
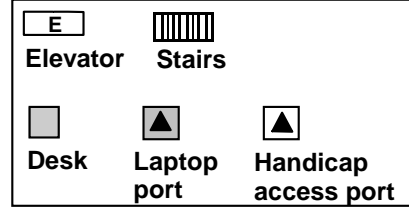

## STACK LEVEL

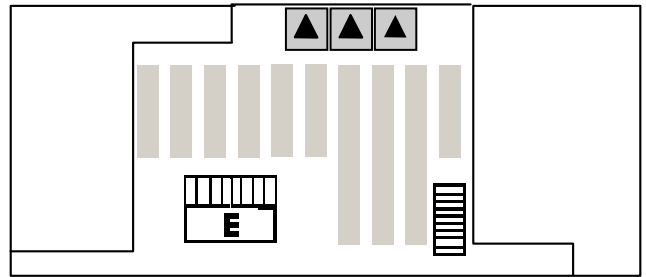

## STACK LEVEL 5

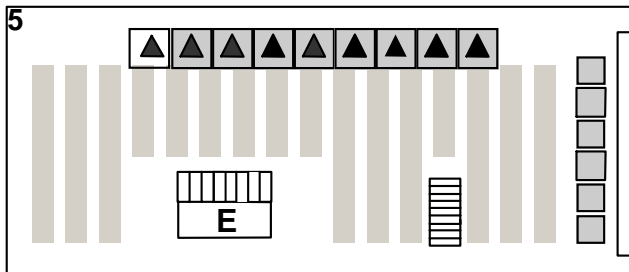

## STACK LEVEL 6, 7, AND 8

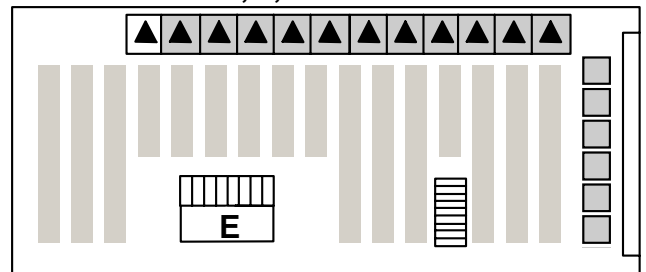

## FLOOR 4, HISTORY AND SPECIAL COLLECTIONS

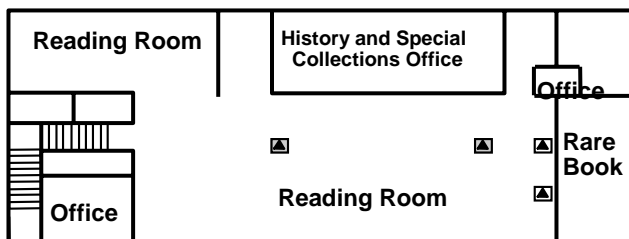

## STACK LEVEL 10 AND 11

